

FEATURES

- For surface mounted applications
- Fast reverse recovery time
- Ideal for automated placement
- Lead free in comply with EU RoHS 2011/65/EU directives

MECHANICAL DATA

- Case: SOD-323W
- Terminals: Solderable per MIL-STD-750, Method 2026
- Approx. Weight: 5.48mg / 0.00019oz

PINNING

PIN	DESCRIPTION
1	Cathode
2	Anode

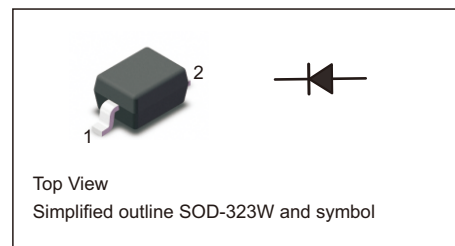

Absolute Maximum Ratings at 25 °C

Parameter	Symbols	Value	Units
Repetitive Peak Reverse Voltage	V_{RRM}	250	V
Reverse Voltage	V_R	200	V
Average Rectified Output Current	I_O	250	mA
Repetitive Peak Forward Current	I_{FRM}	625	mA
Non-repetitive Peak Forward Surge Current @t=10mS	I_{FSM}	1.7	A
Total Power Dissipation	P_{tot}	300	mW
Operating and Storage Temperature Range	T_j, T_{stg}	-55 ~ +150	°C

Characteristics at $T_a = 25\text{ °C}$

Parameter	Symbols	Value	Units
Reverse Breakdown Voltage at $I_R=100\text{ }\mu\text{A}$	$V_{(BR)R}$	200	V
Maximum Forward Voltage at 100 m A at 200 m A	V_F	1.00 1.25	V
Maximum DC Reverse Current at Rated DC Blocking Voltage $T_a = 25\text{ °C}$	I_R	0.1	μA
Typical Junction Capacitance at $V_R=0\text{V}$, $f=1\text{MHz}$	C_j	2	pF
Maximum Reverse Recovery Time ⁽¹⁾	t_{rr}	50	ns

(1) Measured with $I_F = 30\text{ mA}$, $I_R = 30\text{ mA}$, $I_{rr} = 3\text{ mA}$



Fig.1 Power Derating Curve

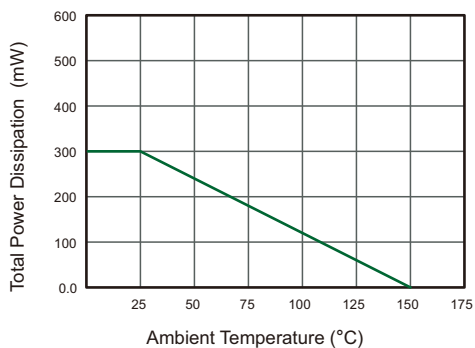

Fig.2 Typical Reverse Characteristics

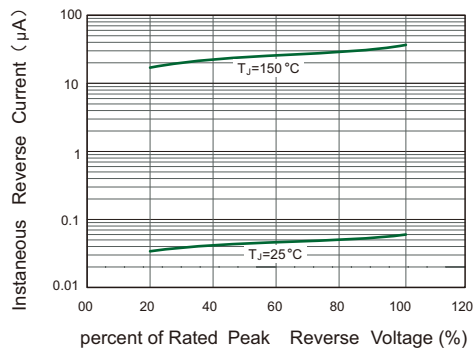

Fig.3 Typical Instaneous Forward Characteristics

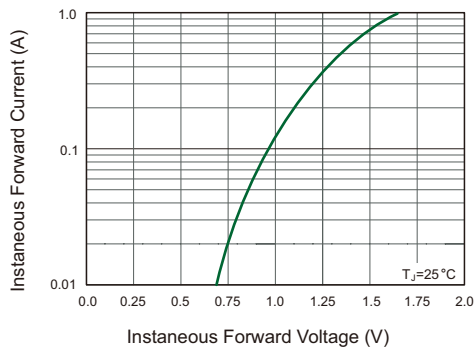
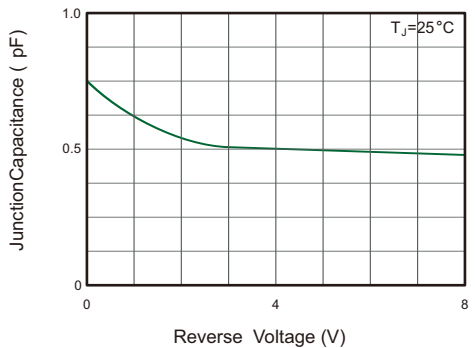

Fig.4 Typical Junction Capacitance





PACKAGE OUTLINE

Plastic surface mounted package; 2 leads

SOD-323W

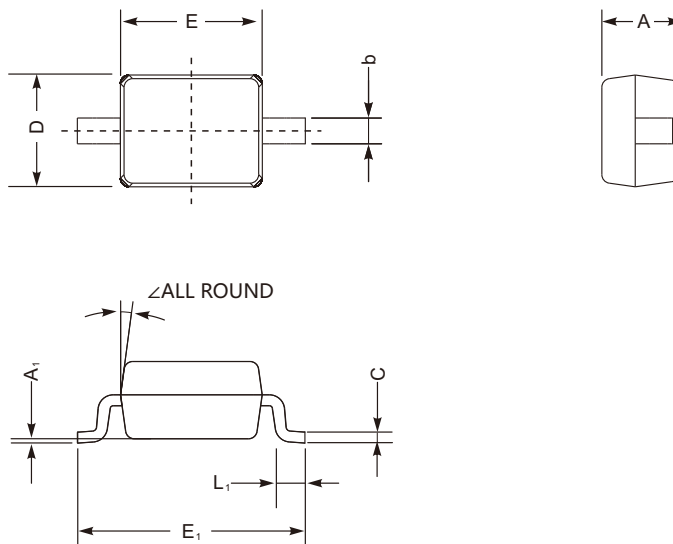

SOD-323W mechanical data

UNIT		A	C	D	E	E ₁	b	L ₁	A ₁	∠
mm	max	1.1	0.15	1.4	1.8	2.75	0.4	0.45	0.2	9°
	min	0.8	0.08	1.2	1.4	2.55	0.25	0.2	—	
mil	max	43	5.9	55	70	108	16	16	8	
	min	32	3.1	47	55	100	9.8	7.9	—	

The recommended mounting pad size

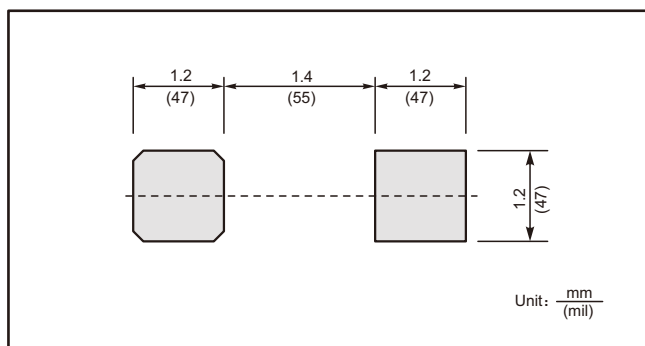

Marking

Type number	Marking code
BAS321WB	A7



Important Notice and Disclaimer

Jingdao Microelectronics reserves the right to make changes to this document and its products and specifications at any time without notice.

Customers should obtain and confirm the latest product information and specifications before final design, purchase or use.

Jingdao Microelectronics makes no warranty, representation or guarantee regarding the suitability of its products for any particular purpose, nor does Jingdao Microelectronics assume any liability for application assistance or customer product design.

Jingdao Microelectronics does not warrant or accept any liability with products which are purchased or used for any unintended or unauthorized application.

No license is granted by implication or otherwise under any intellectual property rights of Jingdao Microelectronics.

Jingdao Microelectronics products are not authorized for use as critical components in life support devices or systems without express written approval of Jingdao Microelectronics.